

WATERFRONT PROJECT 2018 - 2020

PROJECT MAP



UP NEXT – PHASE 2 & 3

The City of Campbell River is now working on the next phases of construction to improve services and access along our waterfront; improving livability, building for the future – and delivering on a vision created by the community. In 2020 work will include underground service upgrades as well as aboveground improvements such as a new roundabout at Rockland Road.

HIGHWAY 19A UPGRADES

PHASE 3A: 2019 COMPLETE ✓
Watermain & Forcemain

PHASE 3B: 2020
Utilities & Roadworks

SEWER UPGRADES

PHASE 2A: 2019 COMPLETE ✓
Forcemain, Big Rock Boat Ramp to Rotary Beach Park

PHASE 2B: 2020
Forcemain from Rotary Beach Park to 1st Ave, Sewer lift stations #4, 5 & 6



#crwaterfrontwork

WATERFRONT PROJECT 2018 - 2020

CONSTRUCTION TIMELINE

After two years of busy construction work, the project team is set up well for a successful completion in 2020. The Waterfront Project has required multiple, often overlapping, phases of construction, and this year that will continue in order to ensure work is finished on time.

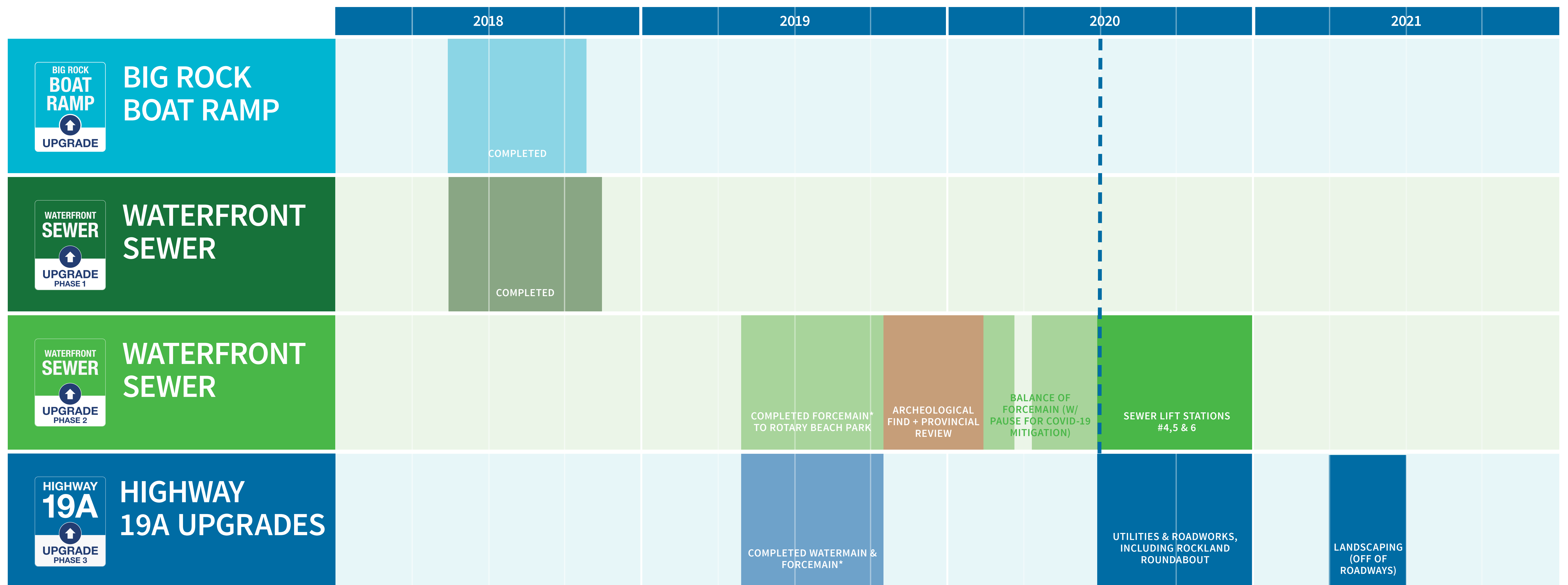

*Some work postponed due to the discovery of a midden in fall 2019, and rescheduled for completion in 2020.





HIGHWAY 19A UPGRADES

INCREASING COMMUNITY AMENITIES

The Highway 19A Upgrades project includes numerous community benefits. Surface improvements – similar to those completed near Simms Creek – will extend another kilometre north. Along with lighting fixtures and centre medians, there are many notable updates.



ACTIVE TRANSPORTATION

No matter how you choose to travel, on foot, by bike, by bus or in a vehicle, the design of the road supports all types of users with varying abilities. Bike lanes will be added through the corridor to support commuting cyclists and those more comfortable on the road. Other cyclists, including children and those who feel less comfortable on a roadway, can cycle on the Seawalk. A formal sidewalk will be installed on the west side, improving pedestrian infrastructure.

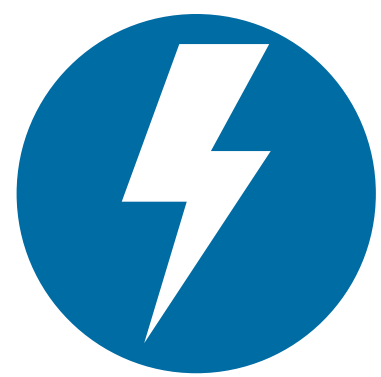

UNDERGROUNDED POWERLINES

The overhead wires through the corridor will be moved underground to beautify this scenic stretch and improve the views. The City has started outreach to affected residents and homeowners in the area about how electrical connections will change at each home.



NEW, MORE PARKING - VEHICLES AND BIKES

A new parking lot will be constructed on the vacant property at the northwest corner of Rockland Road and Island Highway, offering more parking for people using the seawalk. Electric vehicle charging stations will also be provided. Flashing crosswalks will be installed to move pedestrians safely across the road. New roadside angled parking will also be installed north of Rockland Road. Plenty of bike parking is also provided to offer cyclists the opportunity to take a break and enjoy the waterfront.

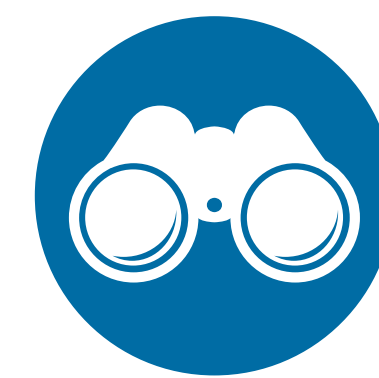

BIG ROCK LOOKOUT

A new lookout at the Big Rock will provide space for people to step off the seawalk to admire this culturally significant landmark, read interpretive signs and enjoy the view.

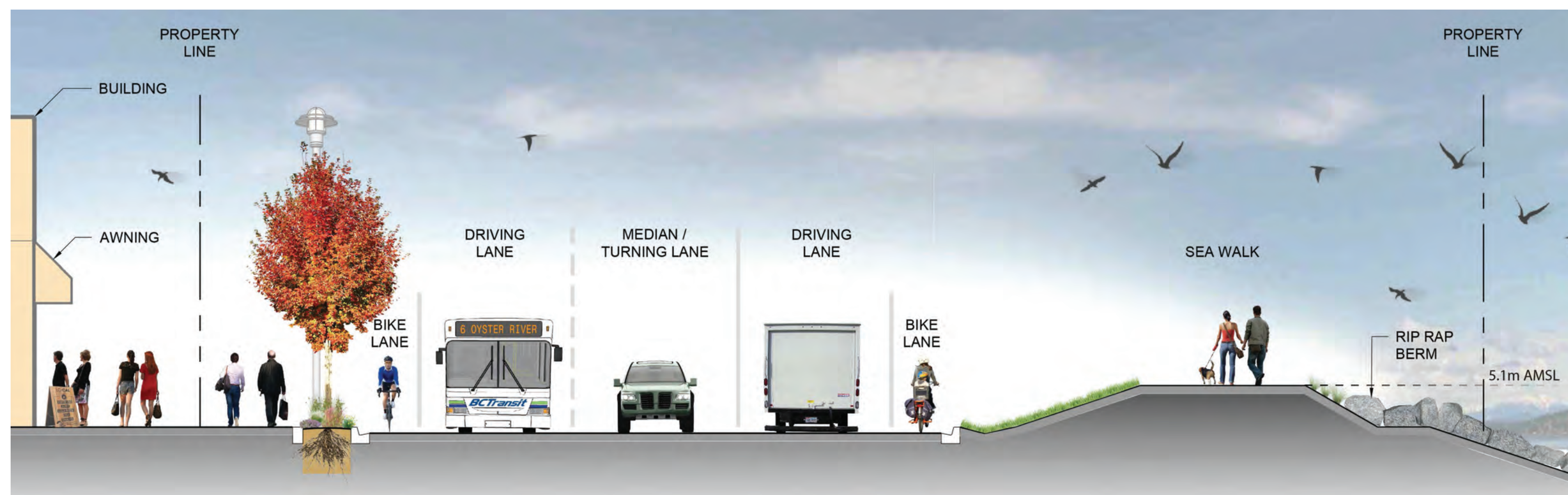

The seawalk will be formally connected and paved between the Simms Creek lift station and Ellis Park.

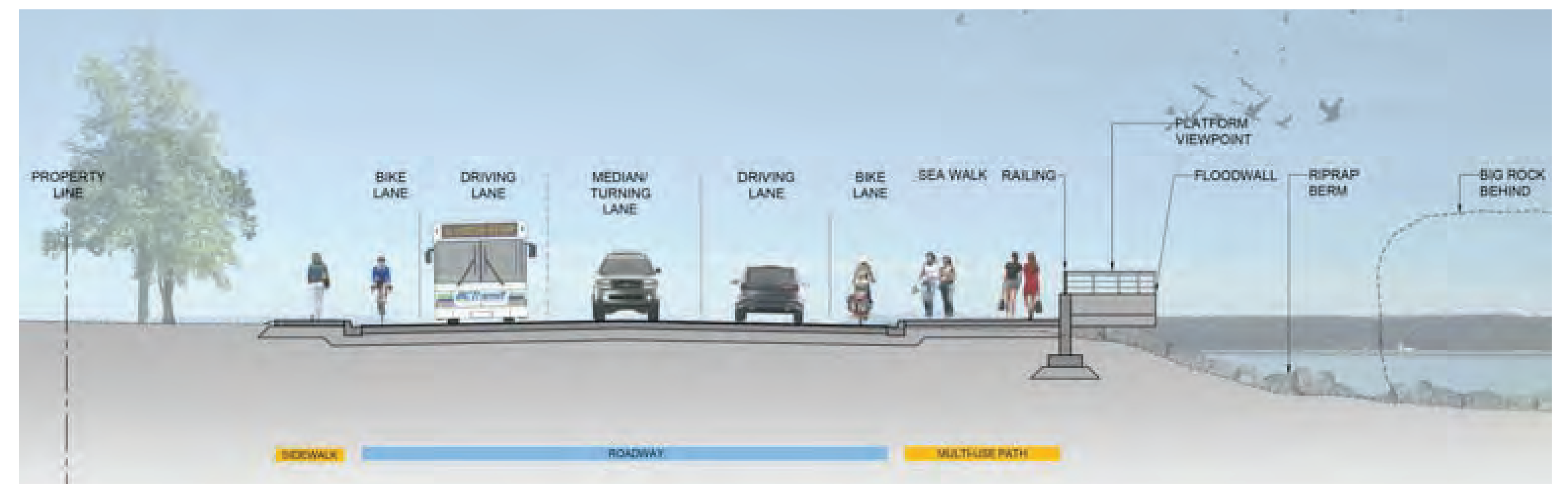

Cross section of the Big Rock Lookout



#crwaterfrontwork



HIGHWAY 19A UPGRADES

WATERFRONT AND PARK ENHANCEMENTS

In 2020, the upgrade will come 'aboveground' providing numerous community benefits. New and improved park spaces enhance waterfront enjoyment and access for all. The three separate park spaces have unique characteristics for a variety of experiences.

● **Ellis Park:** Adjacent to the new Rockland Roundabout, new vehicle parking areas and bus stops, this tiered park provides seating, picnic tables and walkways to enjoy views of the strait and Quadra Island. Serviced with power for community events, the park is accessible to all types of users. A community map provides information of the 28-kilometre “Greenways Loop” (*the Loop*) which the Seawalk is an integral part of. Opportunities for future public art installations are also provided. This enhanced park space is expected to be a popular spot to enjoy the waterfront.

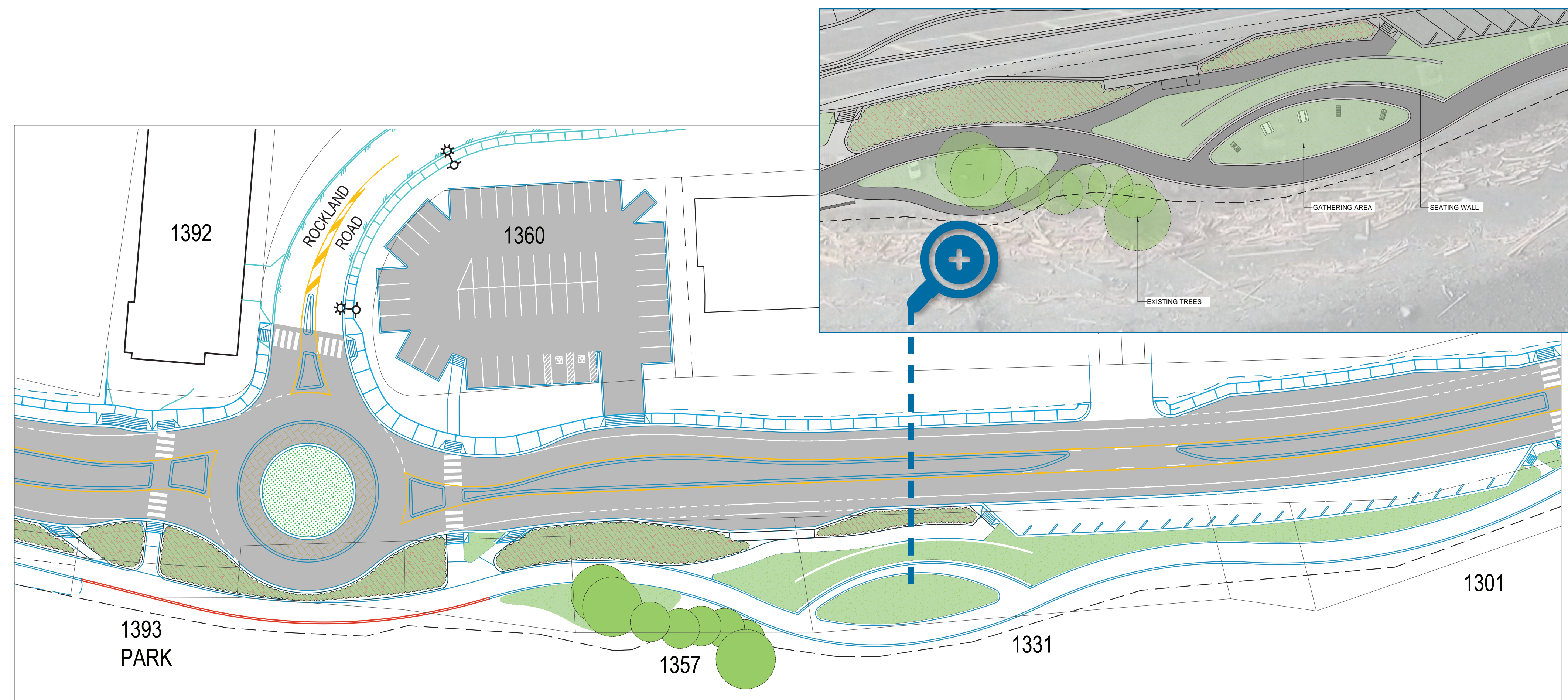

Rendering of Ellis park improvements: design subject to change

● **New Parklet:** Stroll through this new beach access and experience how native plants and trees can provide habitat and naturally anchor the shoreline. This demonstration park includes plantings that are hallmarks of the seaside landscape and are well-adapted to summer drought and windswept winters.

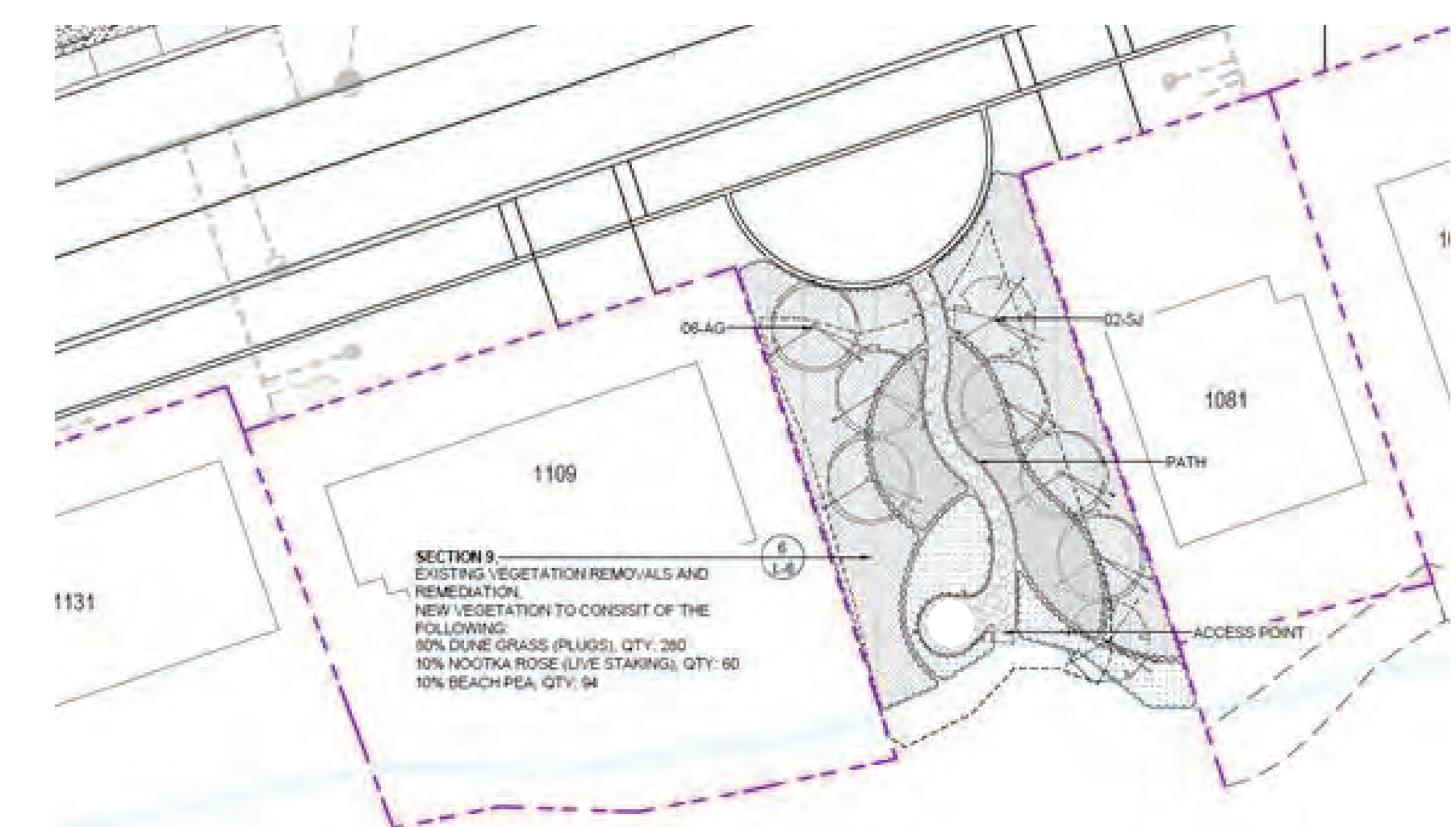

Rendering of new parklet: design subject to change

● **Big Rock Parklet:** This small green space is directly north of Big Rock, has two significant protected trees, provides seating and picnic tables, and includes spaces for future public art. There is also a drinking-fountain for humans and their furry creatures to keep Seawalk users hydrated on their adventures. This park provides an opportunity to take a break, rehydrate and stop for a picnic while cycling *The Loop*.





ROUNABOUT CENTRE DESIGN

TIDAL POOL SELECTED AS FEATURE

In fall 2019, the City of Campbell River went to the community with four proposed design options for the landscape centre feature at the Rockland Road roundabout. The Tidal Pool option was selected as the top choice – thank you to everyone who participated.

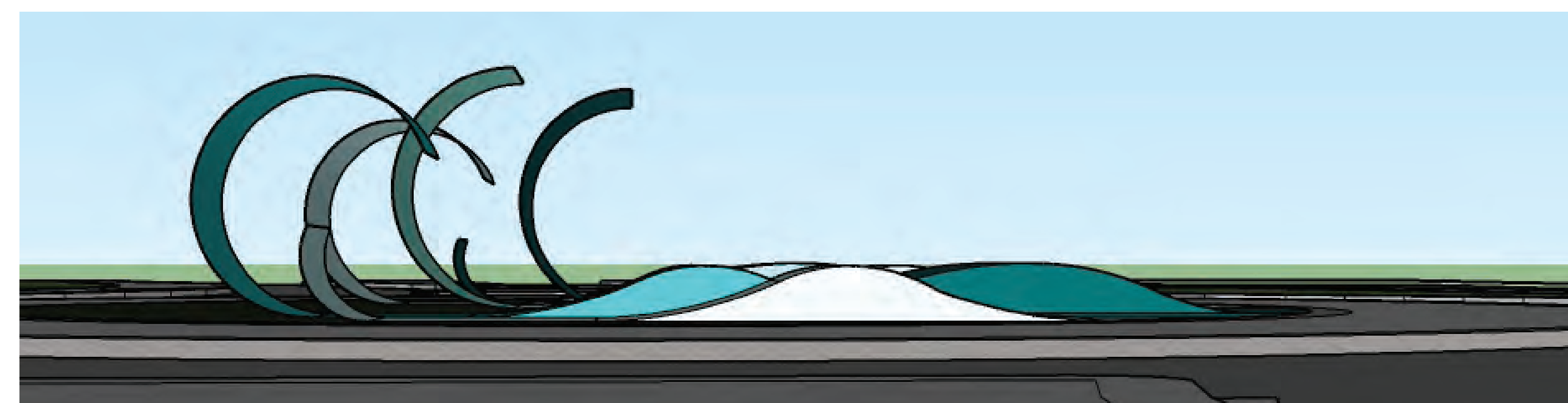
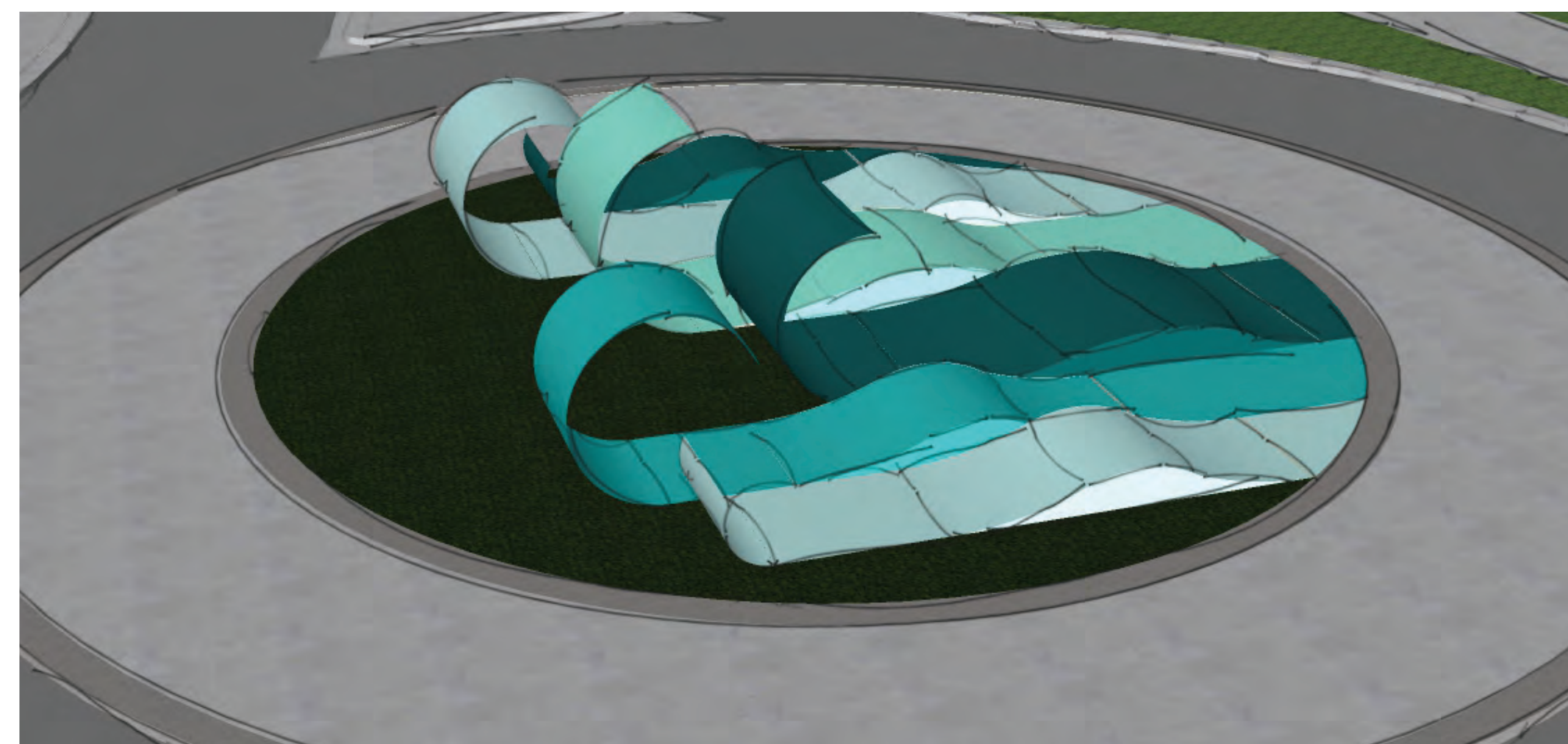

Over 1,300 people accessed the survey, providing input on options and ranking their preferences. Tidal Pool was ranked highest both in weighted calculation and scoring (based on rankings) and on non-weighted totals.

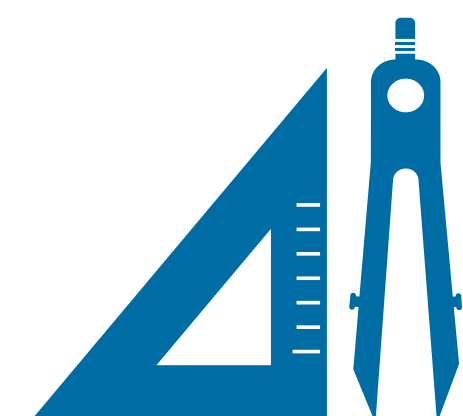

The Tidal Pool concept will now move into detailed design, which will consider the feedback provided by the community and determine a final cost estimate.



Key comments from the public included concern – generally – about safety and visibility with a centre feature and about vandalism or mistreatment of the wave structure. These will be considered in the design stage.



Details about timing for construction are still to be determined and require additional budget estimates.



#crwaterfrontwork



2020 WORK CONSTRUCTION PLAN

This year, 2020, marks the final road construction phase in the three-year Waterfront Project, with work to be completed in December of this year. Here's what's planned:

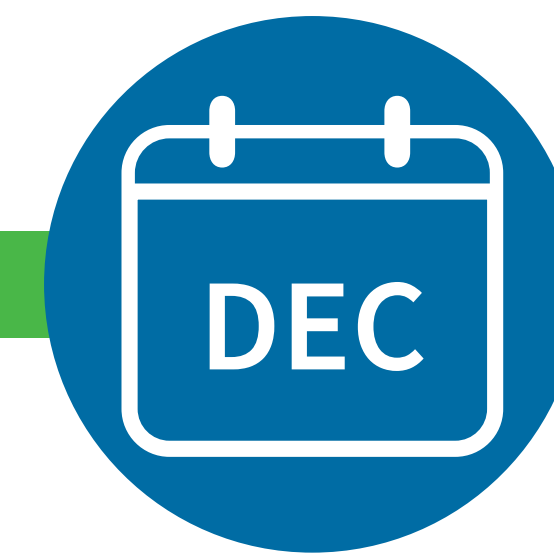

WORK UNDERWAY: Crews mobilize to site and construction starts along highway corridor.

SEWER: Forcemain work continues and remaining water system works completed.

FOCUS MOVES: Sewer work wraps with Rotary Beach Park - 1st Ave paved. New contract – between Rockland and boat ramp – begins.

UNDERGROUND WORKS: The balance of subsurface work (storm, water, sewer) completed.

WIRES AND SURFACE WORK: Powerlines are moved underground and all surface works – including roundabout – completed.

WORK WRAPS: Surface works completed and site is cleaned up. Park areas prepped for final landscaping in 2021.



Photos from 2019 construction



FAQ's: Highway 19A Upgrades – Phase 3

The Phase 3 Highway 19A Upgrades project is part of the overall Waterfront Project 2018-2020, which includes a series of upgrades along the Highway 19A corridor between Maritime Heritage Centre and Rockland Road. See the below FAQs for planned work in 2019 + 2020.

1. What is the project?

The project will see upgrades that both improve services and beautify our city's waterfront. The work includes significant improvements both above- and under- ground, including the reconstruction of sewer and watermains, installation of storm drains, a widened roadway, curb and gutter, sidewalk, seawalk, streetlights, enhanced park spaces, and installation of underground electrical utilities. This work will also improve the function of the highway, through the installation of a roundabout at Rockland Road.

2. Where is the project?

The project is located along a 1 kilometre stretch of Highway 19A, from Big Rock Boat Ramp to Simms Creek Lift Station (approximately 300m south of Rockland Road).



3. When is construction happening?

Construction on this phase will be split into two parts, with Phase 3A beginning in 2019, and Phase 3B in 2020. In 2019, construction work – including the replacement of the underground water and sewer services, in connection with the Waterfront Sewer Project, also underway through the corridor. Work in 2020 on the Highway 19A Upgrades portion is expected to begin in the spring and continue in late fall. Final landscaping work will be completed in 2021.

4. How was the highway design developed?

This project connects to two earlier upgrades south of the route (Phase 1 & 2, completed in 2006 and 2011). In 2005, through an extensive public consultation process, Lanarc Consulting Ltd led the development of conceptual plans for the upgrade from Jubilee Parkway to 1st Avenue.

For Phase 3 of the Highway 19A Upgrades, engineers from McElhanney Consulting are leading the design work. This includes the section from Rockland Road to the Big Rock Boat Ramp site.



FAQ's: Highway 19A Upgrades – Phase 3

5. How is the project being paid for?

The project is a partnership between the City of Campbell River and the Provincial and Federal governments, funded significantly with senior government support of \$6,434,550 through the New Building Canada Fund – Small Communities Fund. With significant funding from senior levels of government, construction costs are reduced for local taxpayers. The total cost of the project is estimated to be \$13.1 million.

6. How will traffic and access be impacted?

Two-way traffic will be largely maintained throughout the corridor, although one-way alternating traffic and intermittent closures will be needed at times and could be implemented without notice. Drivers should expect delays. While originally planned to be closed during construction in 2020, the project team has adapted the project schedule and approach to maintain traffic and reduce the impact on businesses in the area.

7. Will I be able to use the seawalk during construction?

During 2020 construction period, there will likely be periods that the sections of the seawalk will be closed to thru traffic, though the project team will work to keep it open where possible. Users are asked to follow signage and direction from traffic control personnel, as access can change.

8. What is being planned for Rockland Road?

Through the Official Community Plan, Campbell River residents have identified a goal of having the beautiful Highway 19A entrance to the downtown core focused as a scenic destination. To achieve this, a series of highway improvements and traffic calming measures are required. A roundabout at Rockland Road will be included as part of the project, which will both calm traffic through this area, as well as improve safety for all modes of transportation at the intersection. Pedestrians accessing the waterfront area and seawalk will also see improved safety through an increase in the number of designated crossings. The roadway is designed to accommodate all types off vehicles including the necessary emergency services required.

9. What are other highlights of the project?

In 2020, the aboveground work will include exciting upgrades along the corridor, including undergrounding overhead wires, addition of a new public parking area at Rockland Road, an enhanced and improved seawalk, improvements to Ellis Park and construction of a lookout at Big Rock.

10. How can I learn more?

- Information and updates will be posted at www.campbellriver.ca/constructon
- Questions/comments? Email capitalprojects@campbellriver.ca or phone 250-895-1936.
- For updates over the summer, follow us on Facebook or Twitter, just search #crwaterfrontwork.

